

**StarPVCU** window screw codes follow a simple formula - Head, Thread, Point.  
For example:- **C**ountersunk, **S**paced self-tapping thread, **R**einforcement = CSR.  
This prefix is then followed by the size & finish specification to make up the full code e.g. CSR 3.9 x 25 Z.

### HEAD STYLES

**Countersunk**  
for hardware  
fastening

**Shallow Pan**  
for friction stay  
fastening

**Ribbed -**  
Self-sinking for  
reinforcement  
retention

**Faceted -**  
Self-sinking for  
reinforcement  
retention

**Pan -** for  
reinforcement  
retention and  
hardware fastening

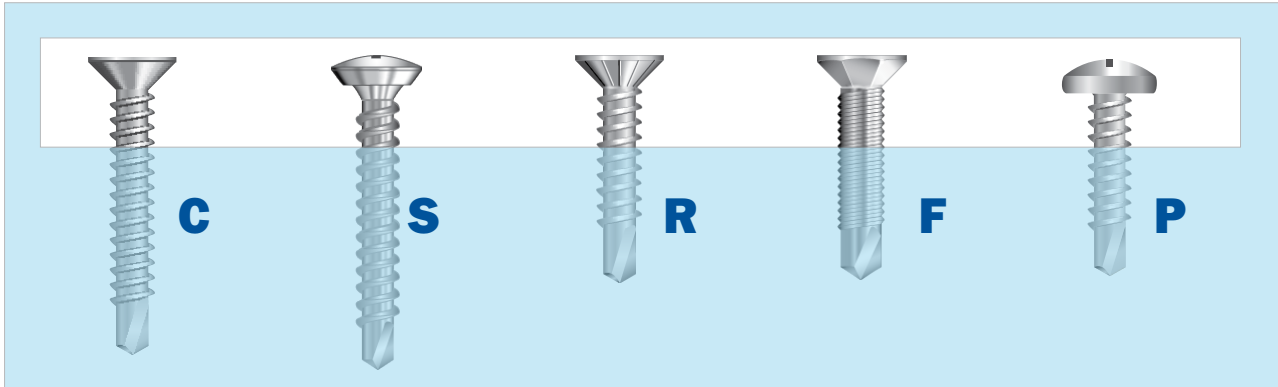

### THREAD TYPES

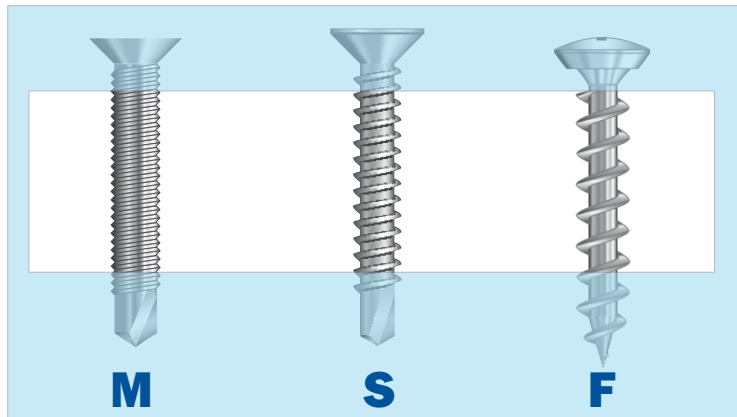

**Metric**  
self-tapping  
for reinforcement

**Spaced**  
self-tapping  
for reinforcement

Single deep  
**Fast** thread  
for PVCU

### POINT STYLES

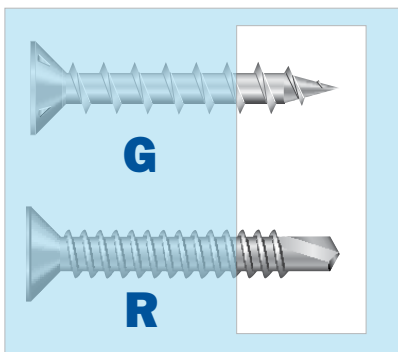

**Gimlet**  
for fastening  
hardware to PVCU

**Drill**  
for fastening  
hardware to  
**Reinforced profile**

### SPECIAL HEAD STYLES



Mechanical jointing

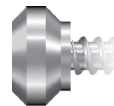

Nipple - for weatherbar  
fastening



Bugle - for cill fastening

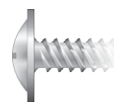

Wafer - many applications  
including baypole assembly  
and installation